

# СТОЛ ХОЛОДИЛЬНЫЙ TATRA TRTGN2D2 TN

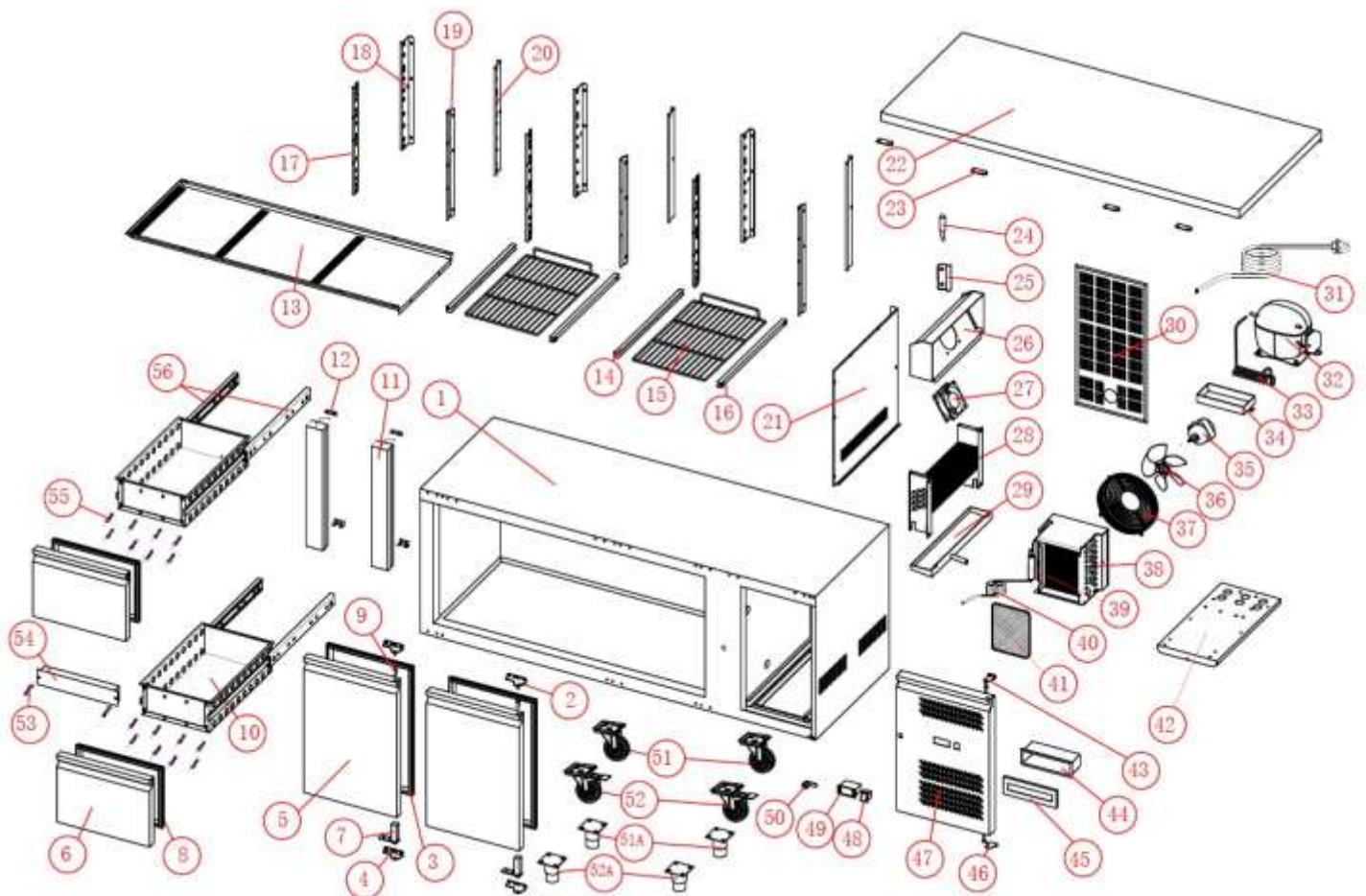

|  |  |  |  |
|--|--|--|--|
|  |  |  |  |
|  |  |  |  |
|  |  |  |  |
|  |  |  |  |

## СТОЛ ХОЛОДИЛЬНЫЙ TATRA TRTGN2D2 TN

|    |                               |                  |    |
|----|-------------------------------|------------------|----|
| 1  | CABINET                       | GXE-0-000-0004-0 | 1  |
| 2  | RIGHT UPPER HINGE             | GXE-2-001-0022-0 | 2  |
| 3  | DOOR GASKET                   | 16401003100      | 2  |
| 4  | RIGHT BOTTOM HINGE            | GXE-2-001-0024-0 | 2  |
| 5  | DOOR(RIGHT )                  | GXE-0-000-0079-0 | 2  |
| 6  | DRAWER DOOR                   | GXE-0-000-0151-0 | 2  |
| 7  | SPRING HINGE                  | 12517240002      | 2  |
| 8  | DRAWER DOOR GASKET            | 16401000206      | 2  |
| 9  | DOOR AXIS SLEEVE              | 16353010008      | 4  |
| 10 | GN1/2 DRAWER                  | GXE-0-000-0150-0 | 2  |
| 11 | MIDDLE BEAM                   | GXE-0-000-0083-0 | 2  |
| 12 | MIDDLE BEAM CONNECT           | GXE-2-001-0017-0 | 4  |
| 13 | AIR GUIDE BOARD               | GXE-2-001-0018-0 | 1  |
| 14 | LEFT SHELF GUIDE              | GXE-2-001-0037-0 | 2  |
| 15 | SHELF                         | 12502012759      | 2  |
| 16 | RIGHT SHELF GUIDE             | GXE-2-001-0036-0 | 2  |
| 17 | BEAM HANG STRIP(LEFT)         | GXE-2-001-0032-0 | 3  |
| 18 | REAR HANG STRIP(LEFT)         | GXE-2-001-0034-0 | 3  |
| 19 | BEAM HANG STRIP(RIGHT)        | GXE-2-001-0031-0 | 3  |
| 20 | REAR HANG STRIP(RIGHT)        | GXE-2-001-0033-0 | 3  |
| 21 | FAN COVER                     | GXE-2-001-0019-0 | 1  |
| 22 | COUNTER TOP                   | GXE-0-000-0006-0 | 1  |
| 23 | TOP FIXING PLATE              | GXE-2-001-0020-0 | 4  |
| 24 | PROBE                         | 17649490013      | 1  |
| 25 | PROBE COVER                   | GXE-2-001-0286-0 | 1  |
| 26 | EVA. FAN COVER                | 16358010001      | 1  |
| 27 | EVA. FAN                      | 17701151238      | 1  |
| 28 | EVAPORATOR                    | 17404040470      | 1  |
| 29 | EVAPOTAROR DRAIN PAN          | 16316130003      | 1  |
| 30 | BACK COVER                    | GXE-2-001-0035-0 | 1  |
| 31 | POWER CORD                    | 17664640059      | 1  |
| 32 | COMPRESSOR                    | 17209010074      | 1  |
| 33 | HIGH PRESSURE PIPE            | 17116060009      | 1  |
| 34 | OUTER DRAIN PAN               | 16316130004      | 1  |
| 35 | COND. FAN MOTOR               | 22752520010      | 1  |
| 36 | COND. FAN BLADE               | 16381738082      | 1  |
| 37 | COND.FAN COVER                | 22726010002      | 1  |
| 38 | CONDENSER                     | 17303090180      | 1  |
| 39 | DRYER FILTER                  | 17111250145      | 1  |
| 40 | CAPILLARY                     | 15804042410      | 1  |
| 41 | DRYER FILTER                  | 16324020004      | 1  |
| 42 | COOLING UNIT BOARD            | GXE-2-001-0026-0 | 1  |
| 43 | CONTROL PANEL UPPER HINGE     | GXE-2-001-0030-0 | 1  |
| 44 | PLASTIC WATER-PROOF BOX       | 16316130001      | 1  |
| 45 | PLASTIC WATER-PROOF BOX COVER | 16316130002      | 1  |
| 46 | CONTROL PANER BOTTOM HINGE    | GXE-2-001-0029-0 | 1  |
| 47 | PANEL                         | GXE-0-000-0087-0 | 1  |
| 48 | POWER SWITCH                  | 17749210020      | 1  |
| 49 | CONTROLLER                    | 17709030002      | 1  |
| 50 | DOOR LOCK                     | 12546100952      | 1  |
| 51 | WHEEL                         | 12533110022      | 2  |
| 52 | FEET(OPTIONAL)                | 12533110010      | 2  |
| 53 | WHEEL(WITH LOCK)              | 12533110023      | 2  |
| 54 | FEET(OPTIONAL)                | 12533110010      | 2  |
| 55 | SCREW(M4*12)                  | 12405034013      | 2  |
| 56 | DRAWER BEAM                   | GXE-0-000-0098-0 | 1  |
| 57 | SCREW(M5*12)                  | 12420340036      | 16 |
| 58 | DRAWER GUIDE                  | 1009009790550    | 2  |